

Conpatch® 600HS

HIGH STRENGTH STRUCTURAL REPAIR MORTAR

DESCRIPTION

Conpatch 600HS is a ready to use one part spray or hand applied fibre reinforced, polymer modified high strength repair mortar.

Conpatch 600HS is suitable for structural repairs in buildings, marine structures, bridges and other infrastructure. It is suitable for structural strengthening and preserving/restoring passivity

Complies to EN1504 part 9 and EN1504 Part 3 class R4 and Part 4.

- Principle 3 : Concrete Restoration (CR).
Method 3.1 - Applying mortar by hand.
Method 3.3 - Spraying concrete or mortar.
- Principle 4 : structural strengthening (SS).
Method 4.4 - Adding mortar or concrete.
- Principle 5 - Increase in physical resistance (PR).
Method 5.3 - Adding mortar or concrete.
- Principle 7 : Preserving or restoring passivity (RP).
Method 7.1 - Increasing cover to reinforcement with additional concrete or mortar.
Method 7.2 - Replacing contaminated or carbonated concrete.

USES & ADVANTAGES

Conpatch 600HS is a fine, ready to use repair mortar for repairing concrete surfaces including honeycombs, surface defects and minor damage. It can also be used to repair corrosive damage to concrete surfaces.

Advantages include:-

- Structural repair mortar.
- Easy to apply. Excellent workability.
- Non shrink. Non toxic. Non corrosive.
- Water & weatherproof.
- Reduces carbonation significantly.
- Excellent adhesion and mechanical strengths.
- Contains no chlorides or salts that may cause corrosion.
- Gives better control and cost saving over two part systems.
- Good colour matching to concrete.
- Non sagging.
- Good resistance to chlorides & sulphates.
- Contains fibres to reduce micro cracking and improve durability.
- High and early mechanical strength.
- Can be applied up to 65 mm thick in single layer.
- Suitable for spray and trowel applied application.
- Also be used as dry pack mortar for various application by adjusting the water content of the mix.

PROPERTIES AND COMPLIANCE

Component:	Single
Appearance:	Grey powder
Compressive Strength:	47 N/mm ² at 1 day
(ASTM C109)	75 N/mm ² at 28 days
Fresh wet Density:	2.25±0.05 kg/ltr.
Pot life:	25-35 min @25 °C
Rapid Chloride Permeability:	very low
(ASTM C1202)	(<800 Coulombs)

Note: The above data is typical under laboratory conditions with water to powder ratio of 0.14. These do not constitute a specification and field trials are recommended.

SUBSTRATE PREPARATION

The substrate should be clean & sound. Remove dirt, dust, oil, grease, laitance, sealers, release agents, curing compounds & paints.

Exposed rebar should be cleaned & protected with **Congard Zinc**.

The concrete should be presaturated for preferably 6 hours with water before application.

Substrate temperature : +5°C min +35°C max.

Ambient temperature : +5°C min +35°C max.

PRIMING

Priming is not normally required. Surfaces to receive **Conpatch 600HS** should be well saturated with water for at least 24 hrs before application. Where soaking with water is difficult, as an alternative method **Cormix Latex** can be used as a bonding bridge.

MIXING

Conpatch 600 HS is simply mixed with water to yield a stiff easily workable compound with shrinkage compensating properties.

The quantity of water depends on the desired consistency but as a guide we recommend 13-15% by weight of **Conpatch 600 HS**.

Mix with a paddle mixer or trowel for at least 3 minutes to ensure a homogenous lump free material is achieved. Do not try to remix the product after losing workability by the addition of more water.

Typical System for Concrete Repair Using Conpatch Repair Mortars



Remove damaged concrete and prepare exposed steel reinforcement.

Thoroughly clean area of repair using high pressure water jet to remove all loose debris and contamination. Fingers should be able to be fitted behind rebar.

Mix and apply **Congard Zinc** to rebar allow to dry. Apply **Cormix Latex** bonding bridge if required. Apply repair material WET ON WET to bonding bridge.

Replace damaged concrete using **Conpatch 600HS** one component polymer modified mortar, build up in layers if necessary.

Once set firm, the repair and surrounding area coat with **Corcure 90** or **Corcure 75** curing compound.

Remove any remaining **Corcure 90** from treated area if to overcoat.

Conpatch® 600HS

HIGH STRENGTH STRUCTURAL REPAIR MORTAR

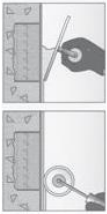

Any further leveling may be achieved with fairing material. A final coat of **Elastoclad** decorative elastomeric, anti-carbonation coating will prevent the ingress of water chlorides and other aggressive influences, effectively halting the carbonation process. **Elastoclad** is water vapour permeable, allowing the substrate to breathe, and has excellent elasticity, bridging dynamically moving cracks even at low temperatures.

METHOD OF USE

Apply **Conpatch 600HS** with a trowel, spatula, float or by spray. By hand press hard. Work up to recommended thickness in a single layer. Thicker repairs may be achieved by working in layers.

CURING

To prevent rapid surface drying and crazing, use a suitable curing compound from Cormix's **Corcure** range e.g. **Corcure 90**.

APPLICATION THICKNESS

	<u>Horizontal</u>	<u>Vertical</u>	<u>Overhead</u>
Min	5 mm	5 mm	5 mm
Max	65 mm	50 mm	30 mm

YIELD

12.4 ltr/25 kg.

COVERAGE

2.2-2.3 kg/m²/mm.

LIMITATIONS

- During hot weather use chilled water for better workability.
- It is recommended to take adequate measures during placing at high temperatures.
- Properties may change for spray application for the cured material.
- Do not add water or rework with the mixed material which has begun to set.

PACKAGING

25 kg. 4 ply plastic lined bags.

STORAGE & SHELF LIFE

Conpatch 600HS has a shelf-life of up to 12 months in unopened packs kept in a dry store. If high humidity is apparent the life may be reduced to 6-9 months.

HEALTH & SAFETY

Conpatch 600HS is non-toxic but is alkaline in its nature. When applying gloves & goggles should be worn. Wash off splashes to skin with water. If in eyes wash out with plenty of clean water and seek medical attention. **Conpatch 600HS** is non-flammable.

TECHNICAL SERVICE

The Cormix International Technical Service Department is available to assist you in the correct use of our products and its resources are at your disposal entirely without obligation.

QUALITY ASSURANCE

ISO 9001: 2015 verified by TUV Nord.
ISO 14001 : 2015 verified by Lloyd's Register International

CONTACT DETAILS

Cormix International Limited
89 Romkiao Rd., Sansab, Minburi, Bangkok 10510
Tel. (66 2) 917 3955-8, 117 3396
<http://www.cormix.com>
E-mail: info@cormix.com