

Contite® WS3

ONE PART POLYMER MODIFIED WATERPROOFING SLURRY

DESCRIPTION

Contite WS3 is a economical, one part cementitious polymer modified waterproofing slurry containing waterproofing additives. It gives strong adhesion and excellent waterproofing. For use in contact with potable water.

Contite WS3 Conforms to the requirements of BS EN 1504-2:2004 Principles 1.3, 2.2 & 8.2

USES & ADVANTAGES

Contite WS3 is a waterproofing slurry for use in structures such as:

- Basements
- Water Tanks
- Water Reservoirs
- Culverts
- Underground Garages
- Planter Boxes
- Fountains
- Tunnels
- Silos
- Terraces
- Bathrooms
- Kitchens
- Supporting walls
- Retaining walls.

Contite WS3 Conforms to BS 8102:1990 as a polymer-cement based waterproof coating for Type A shallow basement structures - Grades 1, 2 and 3.

Once applied the following benefits are apparent:-

- Permeable to vapour.
- Non toxic.
- Very good adhesion.
- Waterproofs concrete and mortar.
- Allows substrate to breathe.
- Chloride free.
- For internal and external uses.
- Replaces ordinary cementitious renders & waterproofing screeds.
- Good resistance to carbon dioxide & chloride diffusion.
- Excellent for below grade applications.
- Minimal surface preparation required.
- Can apply to damp surfaces.
- Can apply other finishes over it.

Contite WS3 mixed with water and applied to prewetted cementitious substrates such as concrete, mortar and brickwork will penetrate the pores and become an integral part of the structure. Crystallization in the pores results in their total blockage thus allowing the blockage of water but allowing the substrate material to breathe. Abrasion resistance is also improved.

PROPERTIES

- Appearance:** Grey powder
Pot Life: approx.30 mins. at 20°C
Density: Approx. 2.0 kg/ltr.
Wet Mortar Mixing Ratio: Approx. 5-6 litre of water per bag
Working Temperature: Not less than 5°C
Compressive Strength: >30 MPa ASTM C109/EN196-1
Flexural Strength: 8.5 N/mm² ASTM C-348/EN196-1
Bond Strength to Concrete: 1.0 - 1.2 N/mm²
Water Vapor Permeability Factor u(m-H₂O): 50(approx.)
Water Absorption: <2% ASTM C-140

** Properties are typical under laboratory conditions and do not constitute a specification. Field trials are recommended.*

MIXING

Contite WS3 is supplied ready to use. Add powder to water (5-6 litre per 25 kg. bag) and mix until smooth and lump free. Do not rework stiff material by adding more water. Mix sufficient material to use within 30 minutes.

METHOD OF USE

The surface must be clean, sound with no oil or grease present. Remove loose particles. Repair honeycombs and other imperfections with **Conpatch 600 Series** or another suitable repair material. The surface should be saturated with water before application.

Do not apply during rain or when rain is anticipated.

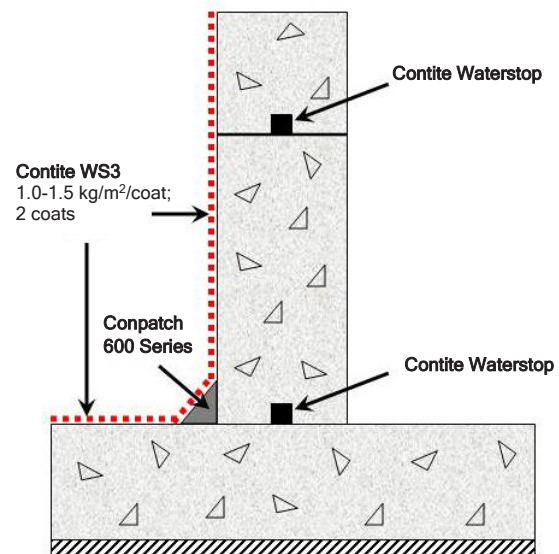

Ground Concrete Wall & Slab/External Waterproofing

APPLICATION

Apply with mortar spraying machine or plastic bristle medium-hard brush. Work slurry well into surface.

Repeat for second coat. The second coat is applied as soon as the first coat is dry enough to wipe (within 24 hours).

A notched trowel may be used for the first coat.

CURING

The effectiveness of **Contite WS3** is ensured if not allowed to dry too quickly. Therefore protect finished coatings against excessively fast evaporation and or strong winds. Protect from rain until fully hardened. Keep moist for 3 - 4 days after application.

Contite® WS3

ONE PART POLYMER MODIFIED WATERPROOFING SLURRY

CONSUMPTION RATE

For standard conditions use 2 coats at 1 kg/m² per coat.

For high water pressure use 2 coats of 1.5 kg/m².

STORAGE & SHELF LIFE

Contite WS3 has a shelf-life of up to 12 months in unopened packs kept in a dry store. If high humidity is apparent the life may be reduced to 6-8 months.

HEALTH & SAFETY

Contite WS3 is non-toxic but is alkaline in its nature. When applying gloves & goggles should be worn. Wash off splashes to skin with water. If in eyes wash out with plenty of clean water and seek medical attention. Contite WS3 is non-flammable.

TECHNICAL SERVICE

The Cormix International Limited Technical Service Department is available to assist you in the correct use of our products and its resources are at your disposal entirely without obligation.

QUALITY ASSURANCE

ISO 9001: 2015 verified by TUV Nord.



Cormix International Limited
89 Romklao Rd, Sansab,
Minburi, Bangkok 10150
09
1012-CPD-0102
EN 1504-2

Protection and repair of
Concrete structures :
Surface protection systems for
concrete coating (PI, MC, IR)

Permeability to CO ₂ :	SD > 50 m
Permeability to water vapour:	SD > 5 m
Capillary absorption and Permeability to water:	< 0.1 kg/m ² h ^{0.5}
Pull-off test:	> 1 N/mm ²
Dangerous substances:	Comply with 5.4
Reaction to fire:	Class E

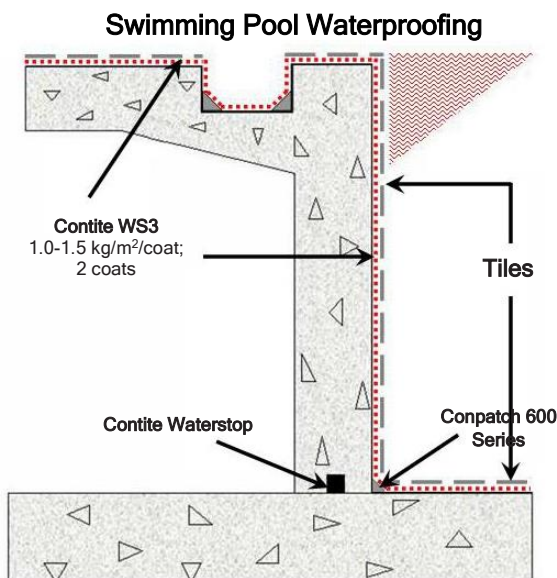
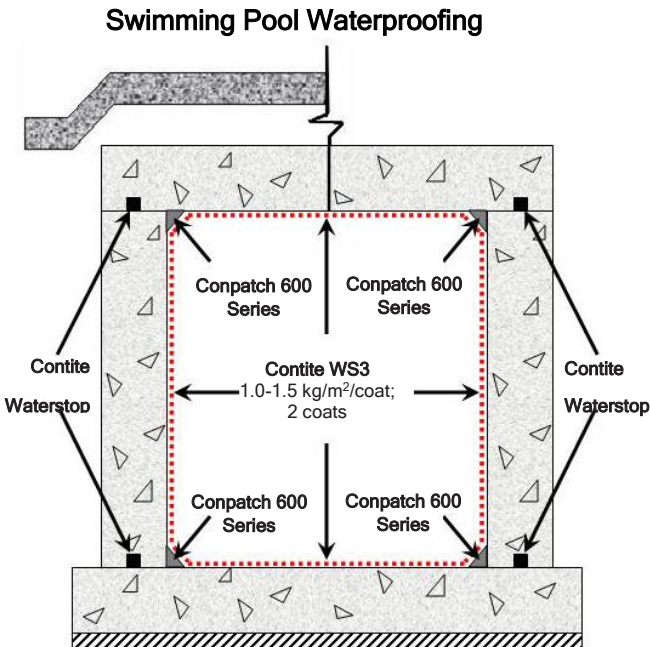

PACKAGING

25 kg. 4 Ply plastic lined bags.

CONTACT DETAILS

Cormix International Limited

89 Romklao Rd., Sansab, Minburi, Bangkok 10510

Tel. (66 2) 917 3955-8, 543 8890

Fax. (66 2) 917 3959, 543 8891

<http://www.cormix.com>

E-mail : info@cormix.com