

## ONE PART POLYMER MODIFIED WATERPROOFING SLURRY

### DESCRIPTION

**Contite WS3** is a economical, one part cementitious polymer modified waterproofing slurry containing waterproofing additives. It gives strong adhesion and excellent waterproofing. For use in contact with potable water.

### USES & ADVANTAGES

**Contite WS3** is a waterproofing slurry for use in structures such as:

- Basements
- Water Tanks
- Water Reservoirs
- Culverts
- Underground Garages
- Planter Boxes
- Fountains
- Tunnels
- Silos
- Terraces
- Bathrooms
- Kitchens
- Supporting walls
- Retaining walls

Once applied the following benefits are apparent:

- Permeable to vapour.
- Non toxic.
- Very good adhesion.
- Waterproofs concrete and mortar.
- Allows substrate to breathe.
- Chloride free.
- For internal and external uses.
- Replaces ordinary cementitious renders & waterproofing screeds.
- Good resistance to carbon dioxide & chloride diffusion.
- Excellent for below grade applications.
- Minimal surface preparation required.
- Can apply to damp surfaces.
- Can apply other finishes over it.

**Contite WS3** mixed with water and applied to prewetted cementitious substrates such as concrete, mortar and brickwork will penetrate the pores and become an integral part of the structure. Crystallisation in the pores results in their total blockage thus allowing the blockage of water but allowing the substrate material to breathe. Abrasion resistance is also improved.

### PROPERTIES

<b>Appearance:</b>	Grey powder
<b>Pot Life:</b>	approx. 30 mins. at 20°C
<b>Density:</b>	Approx. 2.0 kg/m <sup>3</sup> /mm.
<b>Wet Mortar Mixing Ratio:</b>	Approx. 5-6 litre of water per bag
<b>Working Temperature:</b>	Not less than 5°C
<b>Flexural Tensile Strength:</b>	8.5 N/mm <sup>2</sup> ASTM C-348
<b>Bond Strength to Concrete:</b>	1.0 - 1.2 N/mm <sup>2</sup>
<b>Water Vapor Permeability Factor u(m-H<sub>2</sub>O):</b>	50(approx.)
<b>Water Absorption:</b>	<2% ASTM C-140

\* Properties are typical under laboratory conditions and do not constitute a specification. Field trials are recommended.

### MIXING

**Contite WS3** is supplied ready to use. Add powder to water (5-6 litre per 25 kg. bag) and mix until smooth and lump free. Do not rework stiff material by adding more water. Mix sufficient material to use within 30 minutes.

### METHOD OF USE

The surface must be clean, sound with no oil or grease present. Remove loose particles. Repair honeycombs and other imperfections with **Conpatch 600** or another suitable repair material. The surface should be saturated with water before application.

Do not apply during rain or when rain is anticipated.

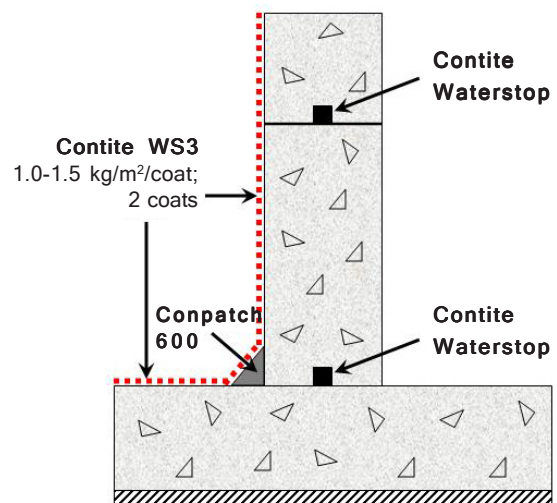

### Ground Concrete Wall & Slab/External Waterproofing



## ONE PART POLYMER MODIFIED WATERPROOFING SLURRY

### APPLICATION

Apply with mortar spraying machine or plastic bristle medium-hard brush. Work slurry well into surface. Repeat for second coat. The second coat is applied as soon as the first coat is dry enough to wipe (within 24 hours).

A notched trowel may be used for the first coat.

### CURING

The effectiveness of **Contite WS3** is ensured if not allowed to dry too quickly. Therefore protect finished coatings against excessively fast evaporation and or strong winds. Protect from rain until fully hardened. Keep moist for 3 - 4 days after application.

### CONSUMPTION RATE

For standard conditions use 2 coats at 1 kg/m<sup>2</sup> per coat.  
For high water pressure use 2 coats of 1.5 kg/m<sup>2</sup>.

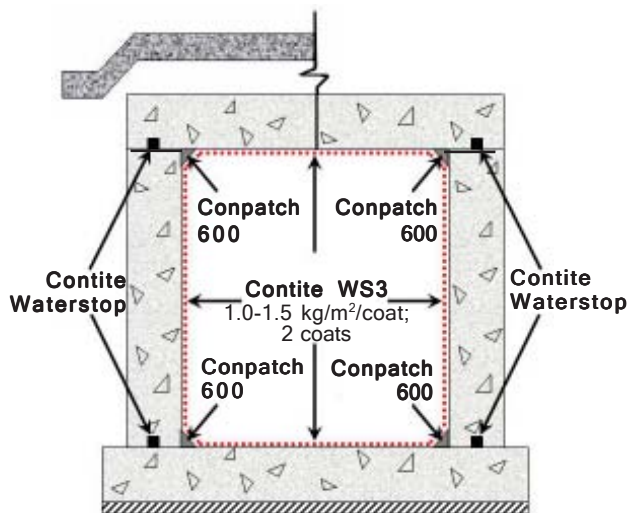

Closed Water Retaining Structure Waterproofing



### Swimming Pool Waterproofing

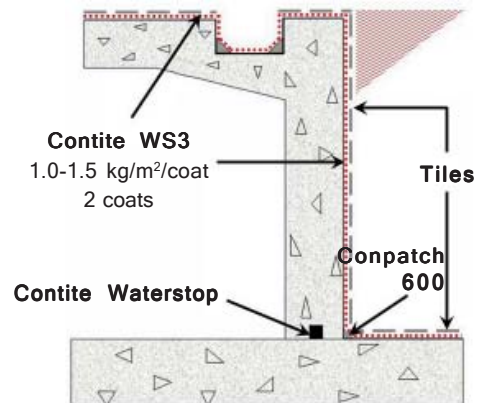

### PACKAGING

25 kg. 4 Ply plastic lined bags.

### STORAGE & SHELF LIFE

**Contite WS3** has a shelf-life of up to 12 months in unopened packs kept in a dry store. If high humidity is apparent the life may be reduced to 6-8 months.

### HEALTH & SAFETY

**Contite WS3** is non-toxic but is alkaline in its nature. When applying gloves & goggles should be worn. Wash off splashes to skin with water. If in eyes wash out with plenty of clean water and seek medical attention. **Contite WS3** is non-flammable.

### TECHNICAL SERVICE

The Cormix International Technical Service Department is available to assist you in the correct use of our products and its resources are at your disposal entirely without obligation.

### QUALITY ASSURANCE

ISO 9001 : 2008 verified by TUV Nord.

### CONTACT DETAILS

#### Cormix International Limited

Regional Office,

89 Romkloa Road, Sansab, Minburi, Bangkok 10510

Tel. (66 2) 917 3955-8, 543 8890

Fax. (66 2) 917 3959, 543 8891

<http://www.cormix.com> E-mail : [info@cormix.com](mailto:info@cormix.com)

**NOTE :** Every reasonable precaution is taken in the manufacture of all CORMIX-products to ensure that they comply with CORMIX's high standard of quality. The recommendations and properties of the product are based upon what is believed to be the most reliable information available, and are not intended as recommendations which infringe on other patents. Although all CORMIX-products are subject to rigid quality tests, no specific guarantee can be given, because results depend, not only on quality, but also on other factors beyond our control. We welcome therefore consultation in the event of doubt concerning application, or performance, and point out that oral recommendations, which vary from the instructions contained herein, are not binding without written confirmation by CORMIX. All transactions shall be subject to our terms and conditions of sale-delivery-and-service. This data sheet supercedes the previous one and a reprint may be issued without notice to supersede this edition, as and when deemed necessary. The information given in this leaflet is to the best of our knowledge true and reliable. Field service where provided does not constitute supervisory responsibility. Our guarantee is therefore limited to the quality of materials delivered.